

P:\Temple\2019\2019-133 WTP Membrane Expansion\CAD\GENERAL\YARD PIPING.dwg - (BC-02) YARD PIPING

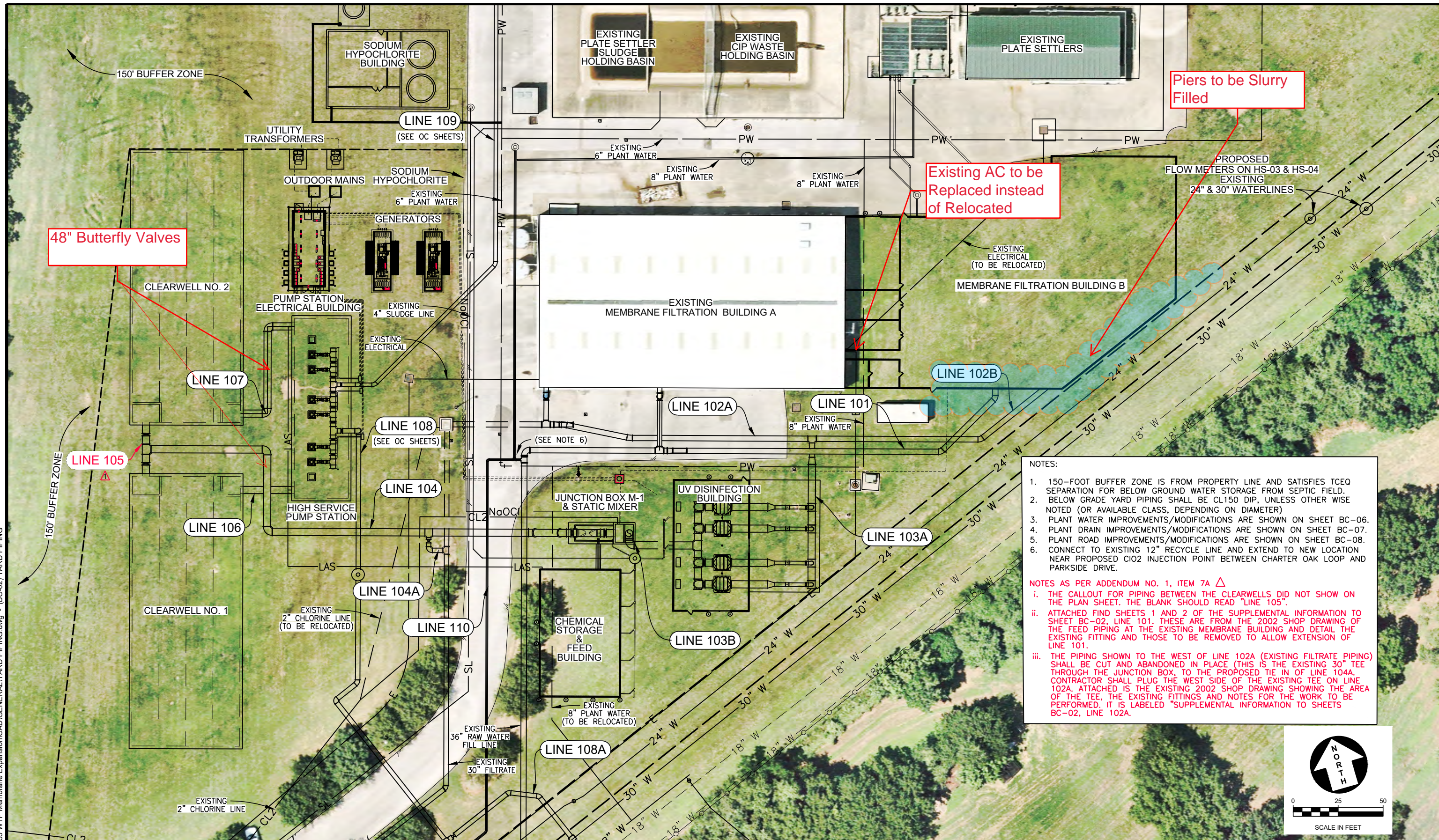

- NOTES:
- 150-FOOT BUFFER ZONE IS FROM PROPERTY LINE AND SATISFIES TCEQ SEPARATION FOR BELOW GROUND WATER STORAGE FROM SEPTIC FIELD.
 - BELOW GRADE YARD PIPING SHALL BE CL150 DIP, UNLESS OTHERWISE NOTED (OR AVAILABLE CLASS, DEPENDING ON DIAMETER)
 - PLANT WATER IMPROVEMENTS/MODIFICATIONS ARE SHOWN ON SHEET BC-06.
 - PLANT DRAIN IMPROVEMENTS/MODIFICATIONS ARE SHOWN ON SHEET BC-07.
 - PLANT ROAD IMPROVEMENTS/MODIFICATIONS ARE SHOWN ON SHEET BC-08.
 - CONNECT TO EXISTING 12" RECYCLE LINE AND EXTEND TO NEW LOCATION NEAR PROPOSED CIO2 INJECTION POINT BETWEEN CHARTER OAK LOOP AND PARKSIDE DRIVE.
- NOTES AS PER ADDENDUM NO. 1, ITEM 7A
- THE CALLOUT FOR PIPING BETWEEN THE CLEARWELLS DID NOT SHOW ON THE PLAN SHEET. THE BLANK SHOULD READ "LINE 105".
 - ATTACHED FIND SHEETS 1 AND 2 OF THE SUPPLEMENTAL INFORMATION TO SHEET BC-02, LINE 101. THESE ARE FROM THE 2002 SHOP DRAWING OF THE FEED PIPING AT THE EXISTING MEMBRANE BUILDING AND DETAIL THE EXISTING FITTING AND THOSE TO BE REMOVED TO ALLOW EXTENSION OF LINE 101.
 - THE PIPING SHOWN TO THE WEST OF LINE 102A (EXISTING FILTRATE PIPING) SHALL BE CUT AND ABANDONED IN PLACE (THIS IS THE EXISTING 30" TEE THROUGH THE JUNCTION BOX, TO THE PROPOSED TIE IN OF LINE 104A. CONTRACTOR SHALL PLUG THE WEST SIDE OF THE EXISTING TEE ON LINE 102A. ATTACHED IS THE EXISTING 2002 SHOP DRAWING SHOWING THE AREA OF THE TEE, THE EXISTING FITTINGS AND NOTES FOR THE WORK TO BE PERFORMED. IT IS LABELED "SUPPLEMENTAL INFORMATION TO SHEETS BC-02, LINE 102A."

	3-25-21	Revision 1, Add. 1, Item 7a, i, ii & iii	AKK
NO.	DATE	REVISION	BY
© 2021 Kasberg, Patrick & Associates, LP			
KPA Firm Registration Number F-510			
Plot Date: Apr 12, 2021 - 12:26pm			
Plotted By: BBAKER			

PROJECT NO.	2019-133
DRAWN BY	Douglas L. Krumnow
DESIGNED BY	Thomas D. Valle, P.E.
APPROVED BY	
DATE	March 25, 2021

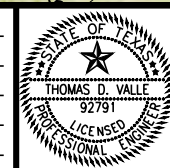

KASBERG, PATRICK & ASSOCIATES, LP
CONSULTING ENGINEERS
TEMPLE, TEXAS 76601

CITY OF TEMPLE, TEXAS
TEMPLE WATER TREATMENT PLANT
MEMBRANE TREATMENT FACILITY EXPANSION
YARD PIPING

SHEET NO. BC-02
OF 11